

# WEST MIDLAND FAMILY CENTER'S

# Family

# F



# CUS

ENHANCING THE QUALITY OF LIFE FOR AREA RESIDENTS OF ALL AGES

VOLUME 11, NUMBER 1 • 4011 W. Isabella Road • Shepherd, MI 48883 • (517) 832-3256 • WINTER 2000

## New Directors and Officers Elected to Lead WMFC

### FROM THE OLD

### The President's Message

*We have much to be thankful for!*

Our major benefactors have pledged the necessary \$2.8 million to make our expansion project a reality. In addition, the Herbert H. and Grace A. Dow Foundation has provided a new 3 for 1 matching grant, up to \$1 million, for our Program Endowment Fund which will help us provide new programs in our enlarged facility.



Bob Dostal

We are indebted to all our contributors, large and small, for their generosity and we are most gratified with their expression of confidence that we are living up to our mission.

In 1999, we were privileged to share, with the west Midland community, the celebration of the 25th Anniversary of West Midland Family Center. This also marked the 10th Anniversary of our current building. Attendance and enthusiasm from our volunteers, our staff, our benefactors - the entire community - made this a truly remarkable year-long recognition of our collective accomplishments. It was truly a great year!

This is my final message to you as Board president. After six years on the Board, five as president, I must leave according to the By-laws. However, I am deeply committed to our mission and our cause. I will continue to play an active role at WMFC. Finally, I must thank everyone for their counsel and strong support during my years as President. It has been most gratifying.

Win Zacharias has been named President of West Midland Family Center, succeeding Bob Dostal who has served in that role for the past five years. Zacharias previously served as President from 1987 through 1992.

The "new" President was one of five new directors elected at the January 3 meeting of the Board. In addition to Zacharias, three others were elected to three-year terms. They are Greg Bergtold, Janet Miller and William Schmidt each of whom were selected for their specific skills and to maintain a balance between local and city residents. Bergtold and Miller are active employees of the Dow Chemical Company, while Schmidt is retired from Dow. Tom Lavigne of Reicker, Van Dam, Barker and Black, was elected as the fifth new Director for one year, completing the term of Steve Carras.

New Officers, in addition to Zacharias, are Jo Ann Winchester, who replaces Sue Thumma as Secretary and Benjamin Dollard, who replaces Joe VanderKelen as Treasurer. James Anderson continues to serve as Vice President.

Appreciation was expressed to retiring Directors Dostal, Charles Infante, Thumma and VanderKelen. Special Certificates of Appreciation are being prepared for presentation at a later date.

The President appointed new Committee Chairpersons at the January meeting. A change in the by-laws made it possible for Committees to be chaired by non-Board members. The Committee chairs for this year are as follows: Accounting and Budget, Ben Dollard; Activities, Jo Winchester; Communications, Jim Burlingame; Dow College Opportunities Program, Gene Wejrowski; Human Resources,

See NEW LEADERS, Page D

### AND THE NEW

### The President's Message

First, I must say I feel highly complimented to be invited back to again serve as a member of the Board of Directors and as your President. It is one more gratifying experience in my 14 years of working with the Center.

In accordance with the WMFC Mission, the year 2000 will mark another giant step forward in preparing the Center to serve the needs of our devoted and supportive users as we move into the new century.

Our capable and dedicated WMFC Staff, our Board and all the Committees and Advisors will face extra challenges as we complete our building expansion project.



Win Zacharias

We must support each other as we work to effectively implement the growth in programming for all age groups from preschool to seniors.

I would be remiss if I did not add my thanks to the retiring Board Members... particularly President Bob Dostal... and to all of you who have collectively gotten us to where we are today. On behalf of WMFC, we solicit the continuing support and outstanding teamwork of all in the Greater Midland Community, who have made and continue to make the accomplishment of our Mission a reality... one step at a time!

### TOLL-FREE NUMBER

If calling WMFC is long distance for you please use our new toll-free phone number: 1-877-631-WMFC (9632).

## WMFC Expansion Project Proceeding "Full Steam Ahead!"

Ground breaking for West Midland Family Center's expansion project is scheduled for spring with completion by February 2001.

Major revisions have been made to the "floor plan," including the new additions and revisions within the existing building. According to Jack Lee, Project Architect with Dow-Howell-Gilmore, the changes "reflect design improvements which better utilize the existing facilities and eliminate the need for some extensive modifications to other elements of the current building."

The classrooms have been grouped together in what might be called the "educational wing."

It is adjacent to the new Administrative segment, which places all offices in a centralized area. The former administrative area will be

See ILLUSTRATION, Page D

converted to a telecommunications center and additional child care space.

The swimming pool has been moved to the rear of the current building so that existing locker room facilities can be utilized, eliminating the need to construct additional locker rooms.

The changes will also create more efficient storage and maintenance space in both the new and existing elements of the new "total" build-

ing, which will nearly double in size. The current makeshift utilization of existing facilities for the library, the food pantry, the donated clothing room and temporary offices will be eliminated, allowing all personnel to operate more efficiently.

Executive Director Greg Dorrien said, "The new, plus the revised, facilities will enable the Center to expand services in every area, with particular emphasis on family support. Also, the pool will make our already popular summer programs increasingly attractive and effective. We're all looking forward with excitement to the project completion."



# We Celebrated 25 Years With Another Year of Remarkable Growth

**Holiday Wrap-up** - A lot of tears of joy were shed in this facility in December from families who could not believe the outpouring of support that occurred. We've had a lot of new people and groups step forward and help this year.



Greg Dorrien

Space limits me from thanking each publicly, but one store went above and beyond and deserves special recognition. **Target** supplied an entire room full of brand new toys and clothes that were gratefully accepted by area families. It enabled us to help every family that requested support, plus others who are too proud to ask. Additionally, many staff members personally donated time and money to make sure no one went without. At times it was stressful for all of us, but when we reflected on

the result, it was worth the extra effort.

**Growth** - 1999 has been another successful year, certainly the best in terms of helping the families and community grow stronger. This is measured in many ways, including less child abuse and neglect, quicker family reunification from foster care, shortening the time children and families are in crisis, and many other ways.

The Center as a corporation certainly has achieved tremendous growth over the last year. The four 25th Anniversary Celebration events generated wonderful community relationships that also increased our visibility. \$2.8 million for the facility expansion was pledged and design is ongoing. Improvements to the current facility included adding air conditioning units in the gymnasium and replacement of the water well with two wells supplying a better quality of water. We also added a second 15-passenger van to our fleet. The total endowment funds

grew more than \$1 million.

**Staff Changes**-**Derek Smith**, Recreation/Wellness Coordinator and **Jessica Pieper**, Family Support Specialist, are both leaving the organization. Jessica has accepted a position with Mid-Michigan Community Action Agency and Derek Smith has accepted a position with East Lansing Recreation and Arts. We congratulate each of them on their professional development and wish them the best.

**Alan Oman** has also taken a new position as Director of North Midland Family Center (see related story). Alan, Jessica and Derek will be missed by all. To help us replace these key losses we welcome two new staff members, **Mary Jeppesen** and **Amy Lesiewicz**. We hope you are ready to hit the ground running ladies, because we need your help desperately!

## WEST MIDLAND FAMILY CENTER

### OFFICERS AND DIRECTORS

President . . . . . Win Zacharias  
Vice President. . . . . Jim Anderson  
Secretary. . . . . Jo Ann Winchester  
Treasurer. . . . . Ben Dollard

Directors: Julie Arbury, Greg Bergtold, Don Koster, Tom Lavigne, Janet Miller, Amber Phillips, Bill Schmidt

Advisors: Jim Burlingame, Michael Custer, Gene Dauer, Bob Dostal, Tom Misner, Chuck Norisez, Alan Oman, Joe Rogers, Sue Thumma, Joe VanderKelen, Roland Weaver, Ralph Wirtz

### STAFF

Executive Director . . . . . Greg Dorrien  
Program Director . . . . . Gail Crosby  
Financial Director. . . . . Rebecca Lampman  
Office Manager . . . . . Diane DeMott  
Receptionists: Teri Booth, Christy Chappel, Diane Dauer, Mary Helton, Jennifer Yarch  
Maintenance Director . . . . . Barry Lenski  
Maintenance Staff: Gerald Burkett, Mike Kirby, Karen Leath  
Dow College Opportunity Director. . Tracy Meister  
Family Services Director . . . . . Renee Shauger  
Family Support Coordinator . . . . . Lois Burton  
Youth & Teen Coordinator . . . . . Wyndy Johnson  
Youth Specialist . . . . . Mary Jeppesen  
Teen Specialist. . . . . Amy Lesiewicz  
Youth & Teen Staff: Amanda Allen, Alex Bartlett, Tom Berlin, Jessica Booth, Cheryl Corpus, Nicki Gainsforth, Stacie Gath, Stephanie Morgan, Tonya Morton, Jason Parks, Andi Strohm, Carla Strong  
Recreation and Wellness Coordinator . . Derek Smith  
Preschool Teachers . . Sarah Batch, Elaine Fabinski  
Preschool Assistant Teacher . . . . . Barb Simons  
Preschool Aides . . . . . Missy Finney, Karen Hall  
Van Drivers . . . . . Robert Shook, Cari Smith  
NEMCSA Head Start Assistant Teacher . Kim Hackett  
Child Care Director. . . . . Ginger Yarch  
Child Care Aides: Sarah Amick, Eileen Burch, Connie Billings, Tricia Chappel, Anabelle Curtis, Mary Ladd, Penny Owen, Nicole Searfoss, Eva Searfoss, Becky Sexton  
Senior Program Staff. . . . . Susan Wells  
Council On Aging Site Manager . . . . . Judy Wirtz

## Dow COP Program Looking for a Few Good Teens

Saturday, January 22, saw WMFC host the third annual Co-ed Snow Pitch Tournament. This year, 14 teams battled each other and the winter elements for the title.

This annual event is held to promote and raise funds for the Center's Dow College Opportunity Program (COP) and the Circle of Health Partnership. The tournament also helped kick off the recruiting process as it gears up to select the class of 2004.

The program offers eighth grade students from Bullock Creek, Coleman, Meridian, and Shepherd the opportunity to participate in an

exciting and challenging leadership program.

Students selected for the program participate in four years of group activities, academic support, cultural events, community service, and individual development. Space for the incoming class is limited. Dow COP Director Tracy Meister notes; "We anticipate a large number of applications this year, but the rewards for those students who are accepted into the program are always enormous." She adds, "Graduating students are eligible to receive up to \$2,000 a year in scholarships while they are in college, as

See COP PROGRAM, Page D

## WMFC 1999 BENEFACTORS:

Organization	Amount
Herbert H. and Grace A. Dow Foundation.....	\$ 1,500,000*
Herbert H. and Grace A. Dow Foundation.....	1,000,000**
Rollin M. Gerstacker Foundation.....	750,000*
The Dow Chemical Company Foundation.....	240,000*
Charles J. Strosacker Foundation.....	220,000*
Dow Corning Foundation.....	90,000*
<b>Organization</b>	<b>Amount</b>
State of Michigan . . . . .	\$ 318,407
United Way of Midland County. . . . .	173,250
Towsley Foundation . . . . .	45,000
Alden and Vada Dow Family Foundation . . . . .	41,000
WMFC Auxiliary . . . . .	32,928
Children's Trust Fund. . . . .	23,058
Rollin M. Gerstacker Foundation . . . . .	20,000
Bastow Foundation Trust . . . . .	17,333
Midland Foundation . . . . .	12,646
United Way Venture Grants . . . . .	11,500
The Dow Chemical Company Foundation . . . . .	10,000
Sunrise Optimist Club . . . . .	4,957
Bergstein Trust Fund. . . . .	4,700
Lee Township . . . . .	4,000
Midland Kiwanis Club . . . . .	4,000
Hudson's . . . . .	3,400
Snow Machines Inc. . . . .	3,000
Charles J. Strosacker Foundation . . . . .	3,000
Greendale Township. . . . .	2,500
Blessed Sacrament Church . . . . .	1,200
Midland County Child Protection Council . . . . .	1,000
First United Methodist Church . . . . .	1,000
Dow High School Student Body . . . . .	984
American Express Voluntary Action Fund . . . . .	800
Midland Daily News . . . . .	724
Midland Jaycees . . . . .	573
D & D Asphalt . . . . .	500
Midland Cogeneration Venture . . . . .	500
Homer United Methodist Church. . . . .	491
Childcare Concepts . . . . .	435
Boy Scout Troop 768 . . . . .	322
Quantum Composites/Premix Foundation . . . . .	250
American Express . . . . .	200
Presbyterian Women . . . . .	200
TOPS Michigan . . . . .	150
Caltech Industries . . . . .	100
Bailey Insurance Agency . . . . .	100
Gordonville United Methodist Church. . . . .	50
Midland County Deputy Sheriff's Association. . . . .	35
Delta Child Study Group . . . . .	20

### Individuals who have contributed:

Timothy & Nancy Aeschliman, Suzie Arbury, Ken & Laurie Babinski, Stuart & Ruth Ann Bergstein, Gary & Jennifer Breneman, Jim and Arlene Burlingame, Mark & Judy Burt, Ruth & Bill Caldwell, Kar Wah Chan & Brunella Gallace, Brandon Crane, Ted & Junia Doan, Ben & Kathy Dollard, Bob & Mary Ann Dostal, Don & Janice Ector, Eugene & Sandra Engle, Mary Gieselmann, Lawrence & Kimberley Hale, Floyd Hall, James Hampton, Virginia Harlow, John & Mary Hinson, Jason Holmes, Robert & Ann Hotchkiss, Cherie Hutter, Keith Johnson, Janet Karlovich & Kenneth Foster, Robert & Mary Kasprzyk, Robert Keil, Joseph & Lynn Krkoska, Mary Ladd, Pete & Gloria Lehman, Ron & Laura Miller, Tom & Elsie Misner, Alan & Julie Oman, Paul & Phyllis Pankratz, Mike & Noreen Parker, Michael & Lori Pekala, Frank & Jean Popoff, Francis Pugh, Sheldon & Mildred Putnam, Leslie & William Rafaniello, Pedro Reinhard, Jerry Schaar, Scott and Janice Sovereign, Bill & Linda Stavropoulos, Ira & Sue Thumma, David & Jeanne Yost, Gilbert & Alice Ward, Jim Williams, John & Jo Ann Winchester, Scott Winchester, Win Zacharias

\* 3-year grant pledge towards the Center's Building Expansion Project.

\*\*5-year matching grant pledge towards the Center's Program Endowment Fund.



# 1999 ANNUAL REPORT

## Budget Summary (Unaudited)

*Figures in Brackets represent actual income and expenses for 1998.*

### 1999 OPERATING INCOME

**TOTAL: \$1,132,228 (\$1,046,705) \***

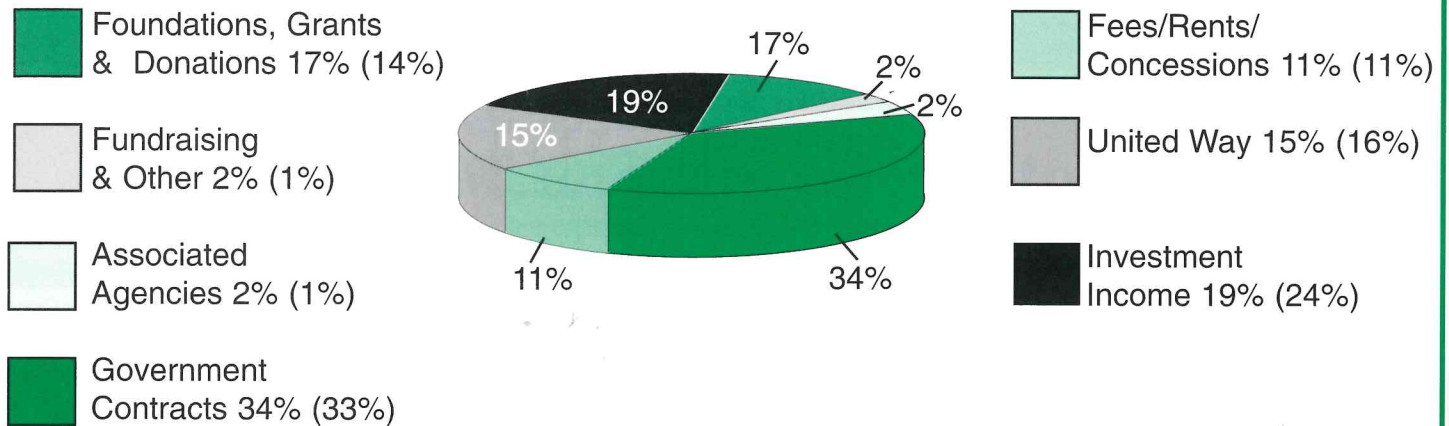

**\*Contributions to Restricted Endowment Fund not included.**

### 1999 EXPENSE

**TOTAL: \$1,086,951 (\$1,054,597)**

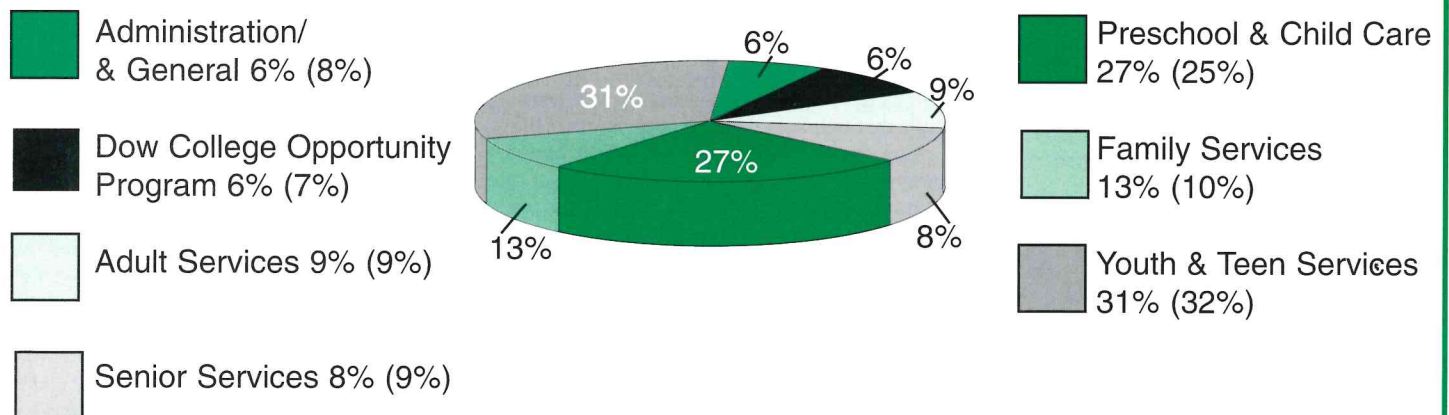

### % PROGRAM GROWTH IN SELECTED PROGRAM AREAS 1996-1999 (UNITS OF USE)

	1996	1997	1998	1999
Preschool & Child Care: (days of care)	5,810	8,433	12,222	13,650
Family Support Services: (individuals served)	219	360	708	745
Summer Programs: (days of service)	3,466	5,277	6,226	6,075
Dow College Opportunity Program: (hours of service)	7,192	8,125	8,715	8,260

### 1999 ESTIMATED VALUE OF VOLUNTEER SERVICES AND DONATIONS

Market Value	
Volunteer Hours: . . . . .	\$260,000
Donated Goods: . . . . .	\$ 85,000
<b>TOTAL WORTH: . .</b>	<b>\$345,000</b>

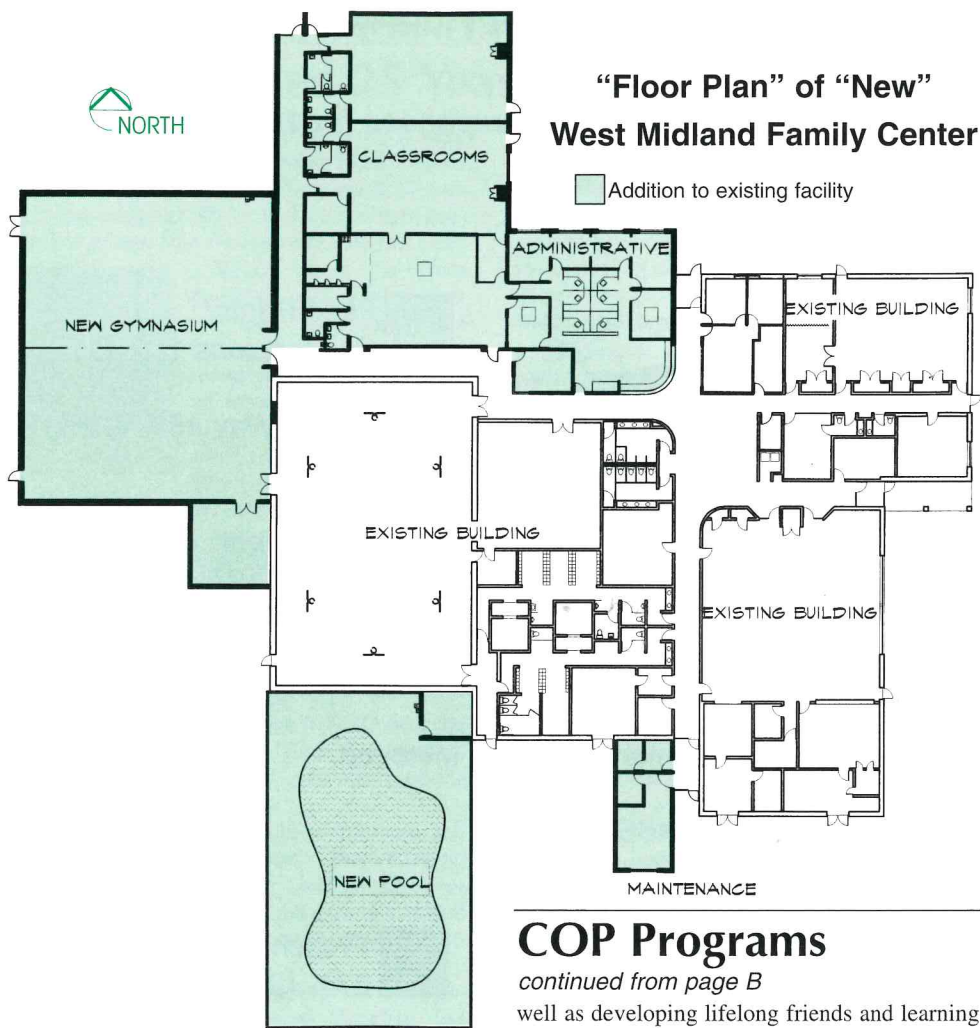

## Alan Oman Director at North Midland

Alan Oman, a West Midland Family Center veteran, has been named the new Director of North Midland Family Center as of February 1.

Oman has been Director of New Initiatives and Promotions at WMFC for the last five years. He started as a Center volunteer after moving to Midland with his wife Julie from Sarnia, Ontario. With a background in community and social services management at the YMCA in Canada, Oman quickly found himself at home.



Alan Oman

During his time at the Center, Oman has helped develop a number of new programs and has worked to increase the profile of WMFC within the Midland Community.

WMFC Executive Director Greg Dorrien said, "Alan will be greatly missed, his vision and passion for advancing the Center's mission have been a great asset to us over the last five years." He added, "I'm sure that his talents will be put to good use at North Midland Family Center and I look forward to working with him."

Director of Programs Gail Crosby, Oman's coworker and office roommate for the last five years, noted; "Alan and I have helped each other grow. We have always thrown ideas back and forth and I think our respective talents have made us a great team." Oman takes over North Midland Family Center at a time when they are planning the construction of their own new facility in Mills Township. "It's an exciting time to be coming on board," he stated. "In many ways, North Midland's development has followed a similar path to that of WMFC. There is great support for both Centers within their respective communities and the residents of the North Midland area are excited and prepared for the challenges of taking the next step."

Of his departure from West Midland Family Center, Oman said, "I am and will always be a supporter and advocate for the Center and what it stands for. WMFC is a special place with a special group of people. I have thoroughly enjoyed my job at WMFC. You just have to love working with such a terrific group of people."

## Center Receives Award from American Express

The American Express Foundation announced in January that West Midland Family Center had received an \$800 grant as one of 175 organizations selected to receive an award from its Volunteer Action Fund. The Fund is an innovative program that awards grants on a competitive basis to eligible organizations at which American Express employees volunteer.

American Express Financial Advisor and West Midland Family Center Treasurer, Ben Dollard said:

"The funds will be utilized to purchase wheelchair accessible play equipment for a new children's playground which will be part of WMFC's upcoming facility expansion. I am proud that American Express is able to support the Center and all their good works."

## "Floor Plan" of "New" West Midland Family Center

## COP Programs

*continued from page B*

well as developing lifelong friends and learning skills that will help them throughout their life."

Acceptance into the program is based upon a number of criteria. The most important are financial need, the student's desire to succeed and improve themselves academically and family support. Applications for the program will be available in February at the Center and area Middle School Counseling Offices. This year's application deadline is March 15.

D

## New Leaders

*continued from front page*

Joe VanderKelen; Investment, Ben Dollard and Facilities, Don Koster. The Boards Expansion and Fundraising Sub Committees will be chaired by Bob Dostal.

U.S. POSTAGE  
NON-PROFIT ORGANIZATION  
PAID  
Midland MI  
Permit #153

WEST MIDLAND FAMILY CENTER  
4011 Isabella Road  
Shepherd, MI 48883